

**Presbytery of Western North Carolina**  
**July 30, 2019**  
**Brevard-Davidson River Presbyterian Church**  
**249 East Main Street**  
**Brevard, NC 28712**  
**828-884-2645**

**Hotels**

Hampton Inn - 883-4800

Holiday Inn Express - 862-8900

**Restaurants**

Fall's Landing - 884-2835 (East Main Street)

Mayberry's - 862-8646 (West Main Street)

Quotations (next to the church) 883-8966

Grand Buffet - 883-3197 (Chinese near Holiday Inn Express)

Hawg Wild Bar-B-Que (near Hampton Inn)

Pisgah Fish Camp (near Hampton Inn) - 877-3129

**Directions to Brevard From Asheville:**

- I26 to Asheville Regional Airport
- Take 191 West to Mills River 280 to Brevard
- 64 to Main Street turn left on Main Street, through two traffic lights, ½ a block past second light church will be on left, red brick church

← PARKING →

← PARKING →

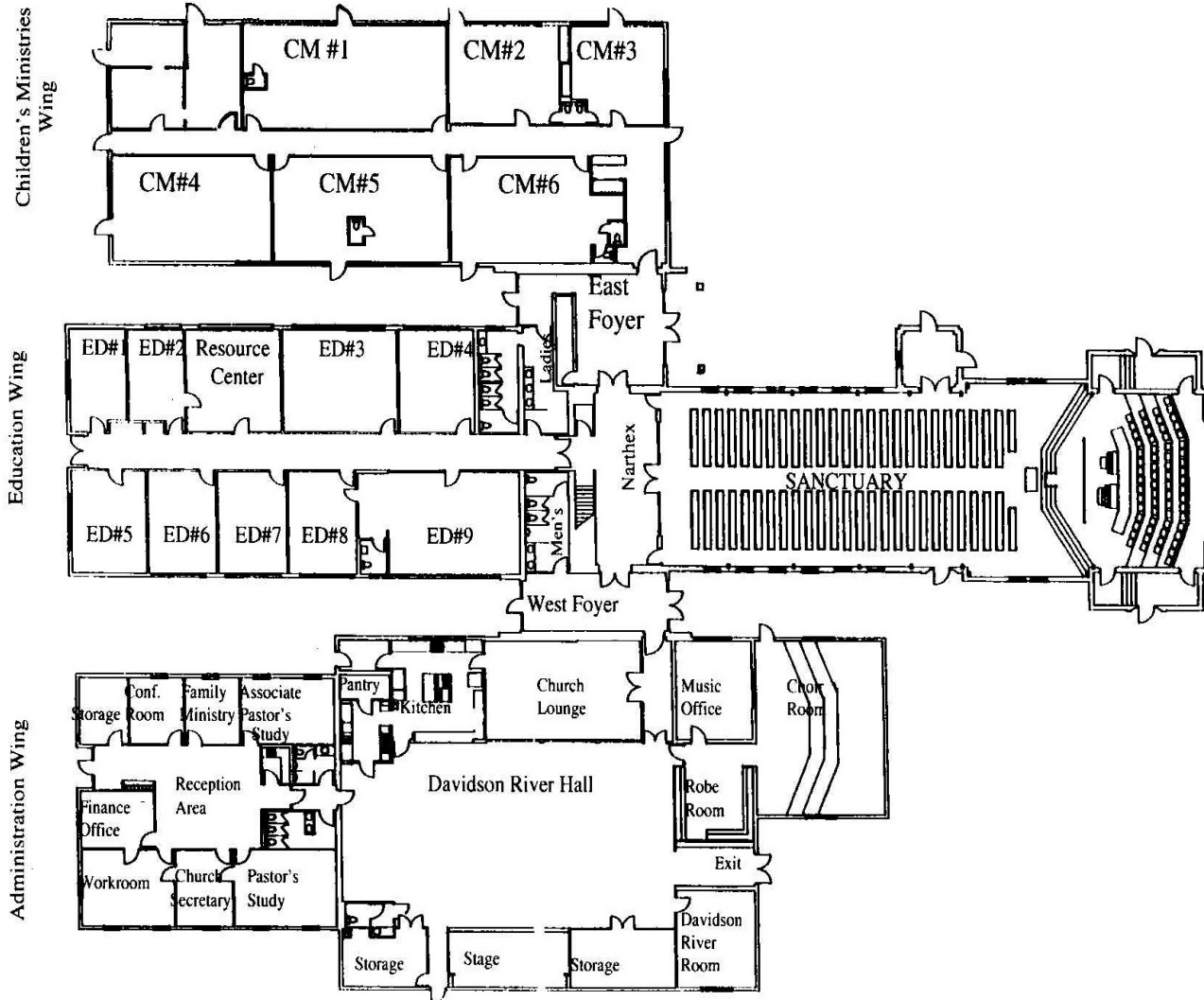

CM = Children's Ministries Wing  
ED = Education Wing

← PARKING →

MAIN STREET